

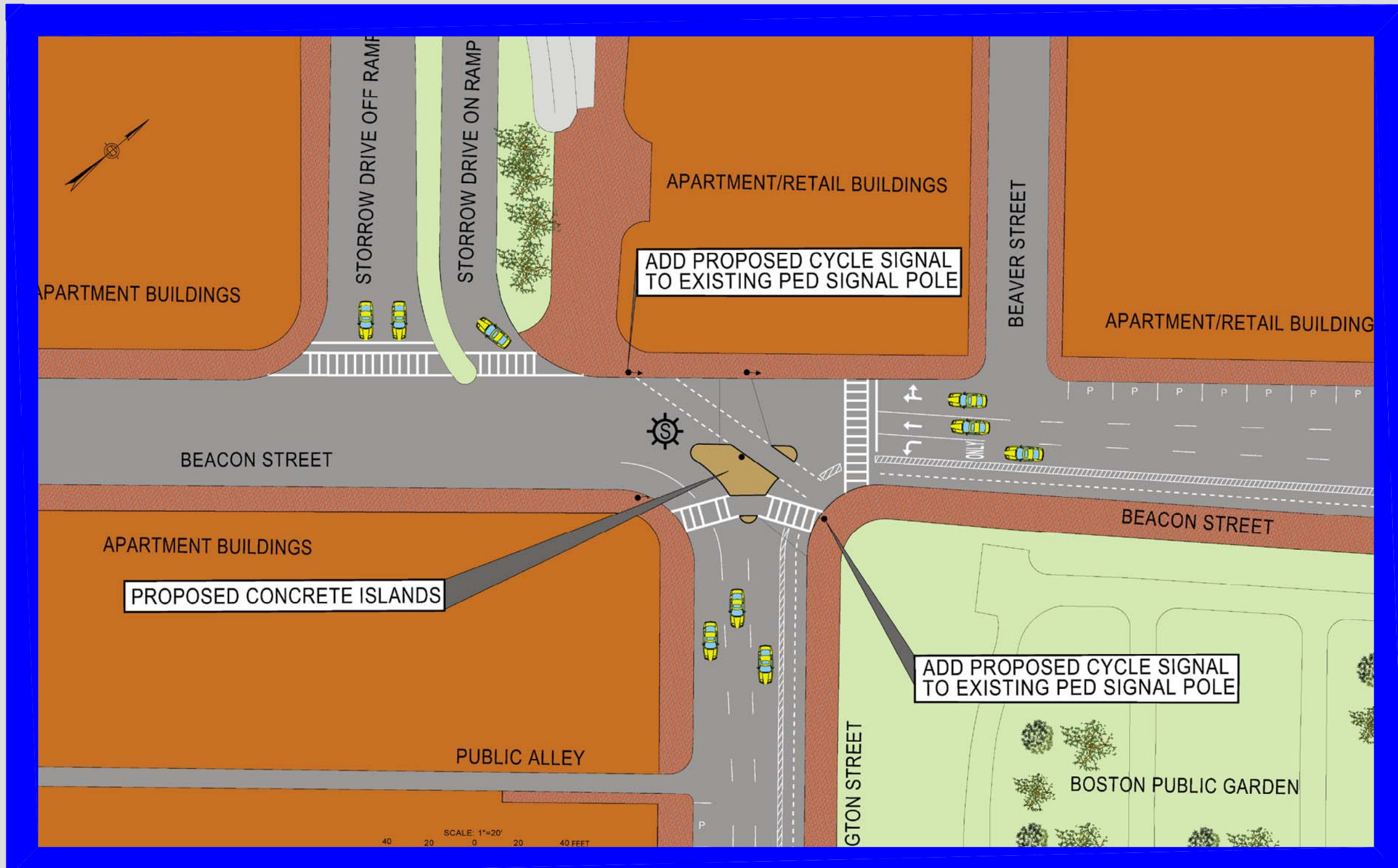

BOYLSTON STREET CYCLE TRACK



TWO-WAY SEPARATED CYCLE TRACK CONNECTING THE BACK BAY FENS TO DOWNTOWN



BEACON STREET AT ARLINGTON STREET

- CONNECTION TO THE ESPLANADE VIA THE ARTHUR FIEDLER FOOTBRIDGE
- CONCURRENT PEDESTRIAN AND BICYCLE PHASES

FEASIBILITY OF A LANE REMOVAL

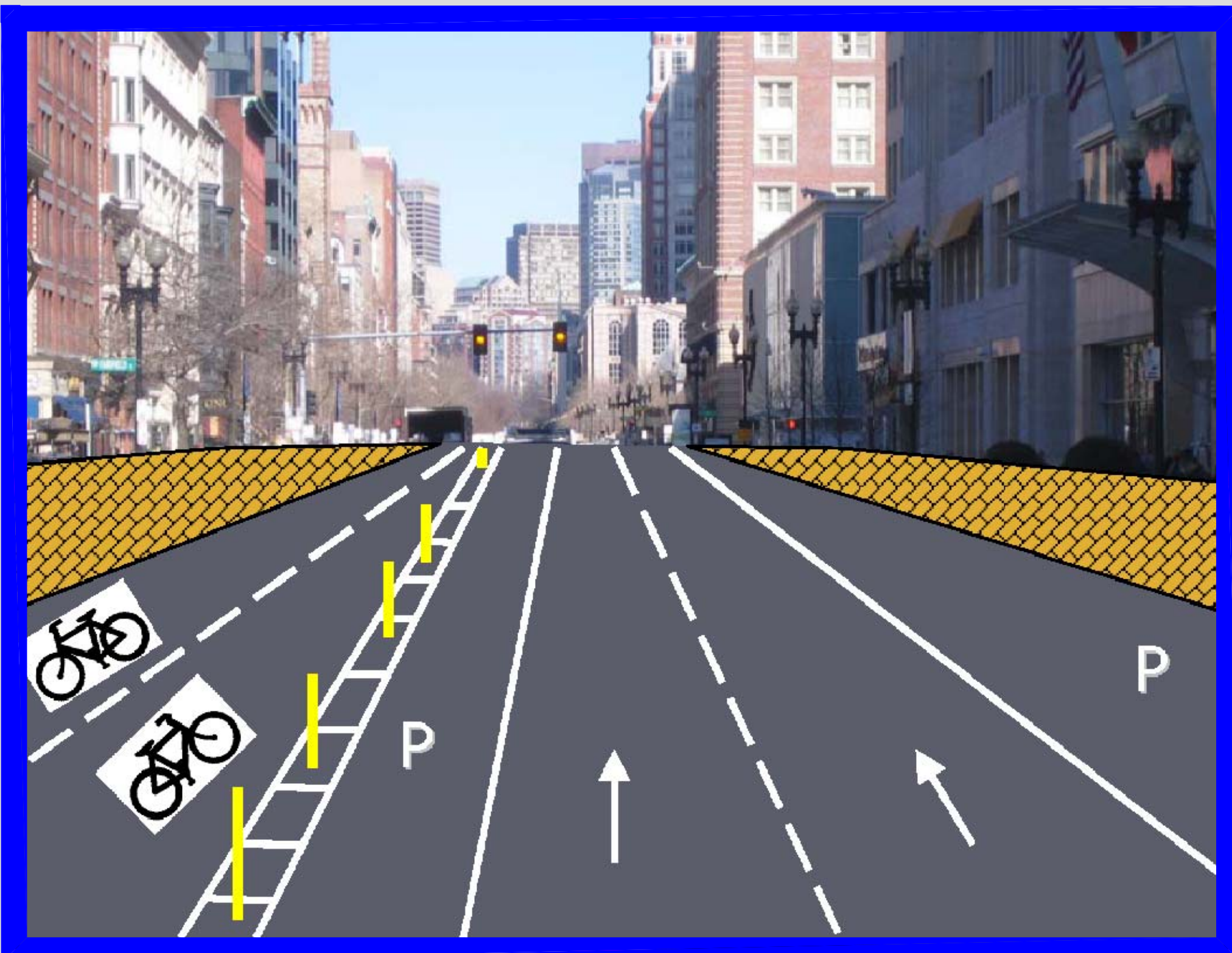

PROPOSED BOYLSTON ST. CROSS-SECTION

- EXISTING CURB IS RETAINED
- NO LOSS OF PARKING SPACES
- VEHICULAR DELAY IS NOT INCREASED

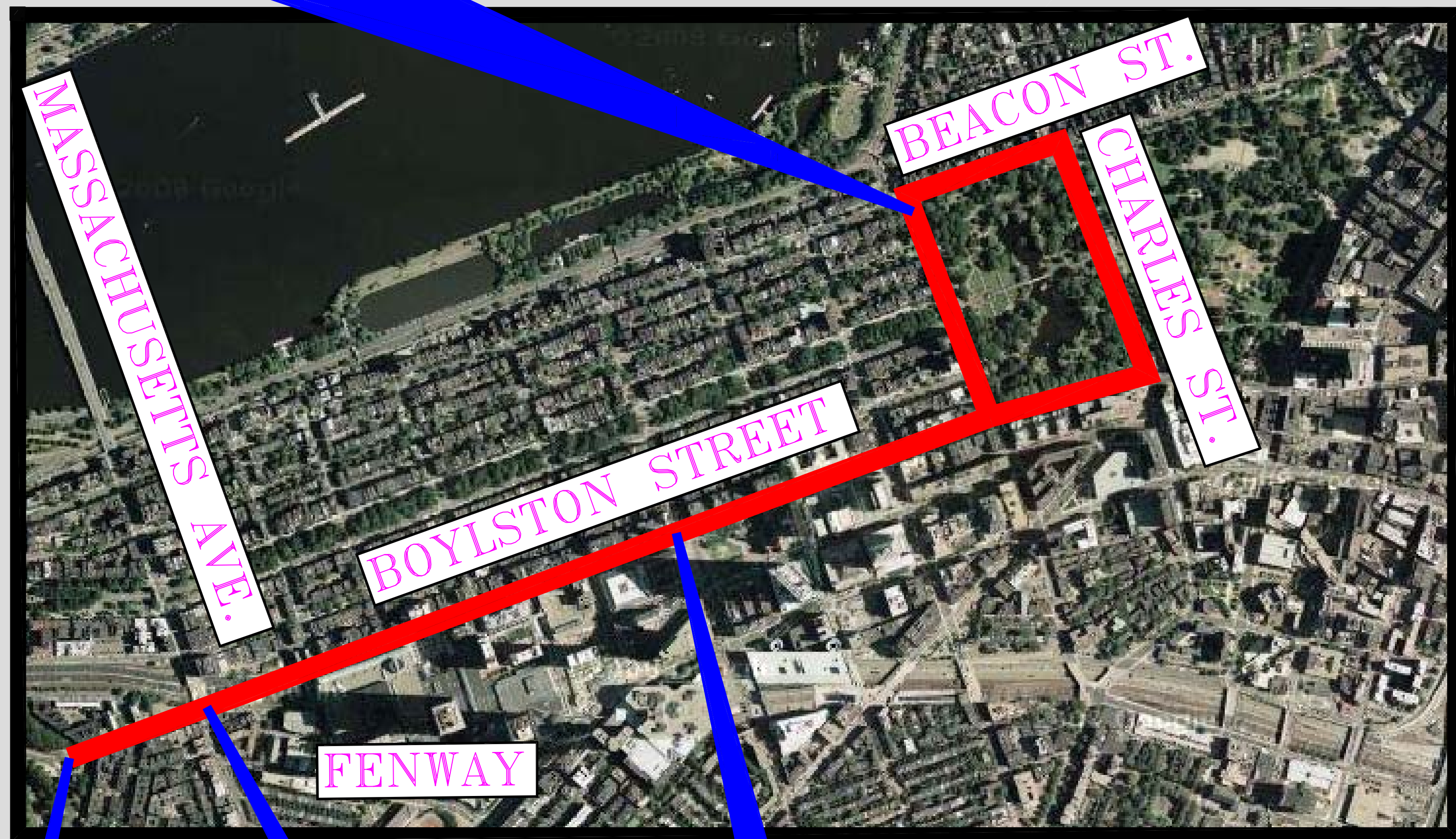

ABSTRACT

The Boylston Boneshakers are proud to present a feasible design for a continuous two-way cycle track on Boylston Street from Fenway to and around the Public Garden. The cycle track design maintains existing curb widths by removing one travel lane while still maintaining acceptable vehicular traffic. The cycle track is separated from moving vehicles by a buffer zone and parked vehicles to increase safety and encourage commuters and recreational cyclists to ride through Boston.

Not only would this route serve as a connection between communities in Boston, but it would also attract bicyclists to downtown Boston to enjoy the beautiful Public Garden and historical Boston Common. Promoting bicycling within the city of Boston will reduce vehicular traffic and parking problems, and promote a healthy lifestyle.

James Barnack, Sean Carr, Tom Leduc, Dan Liepins

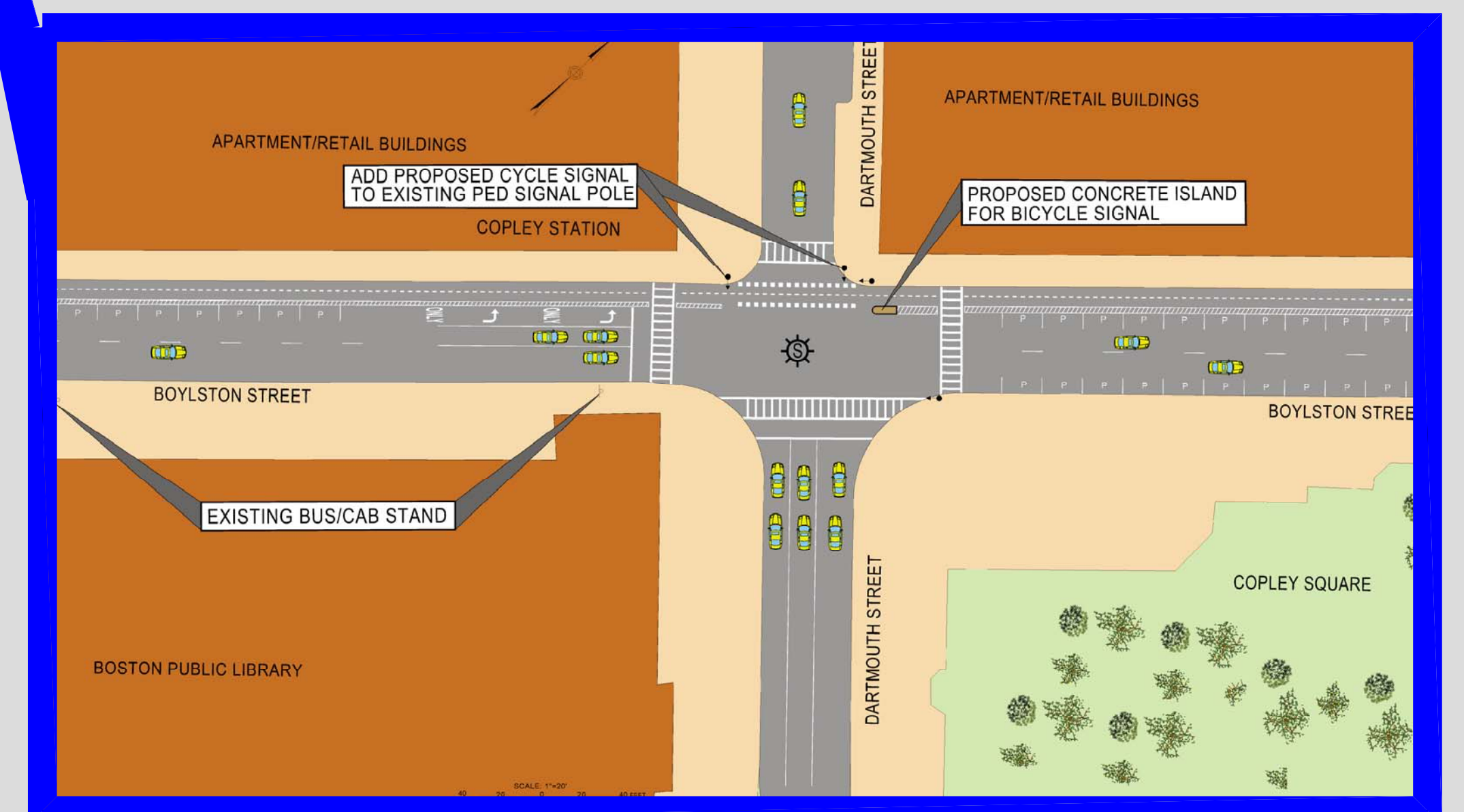

BOYLSTON STREET AT DARTMOUTH STREET

- LEADING CONCURRENT PEDESTRIAN AND CYCLE PHASES
- EXTENSION OF LEFT TURN BAY

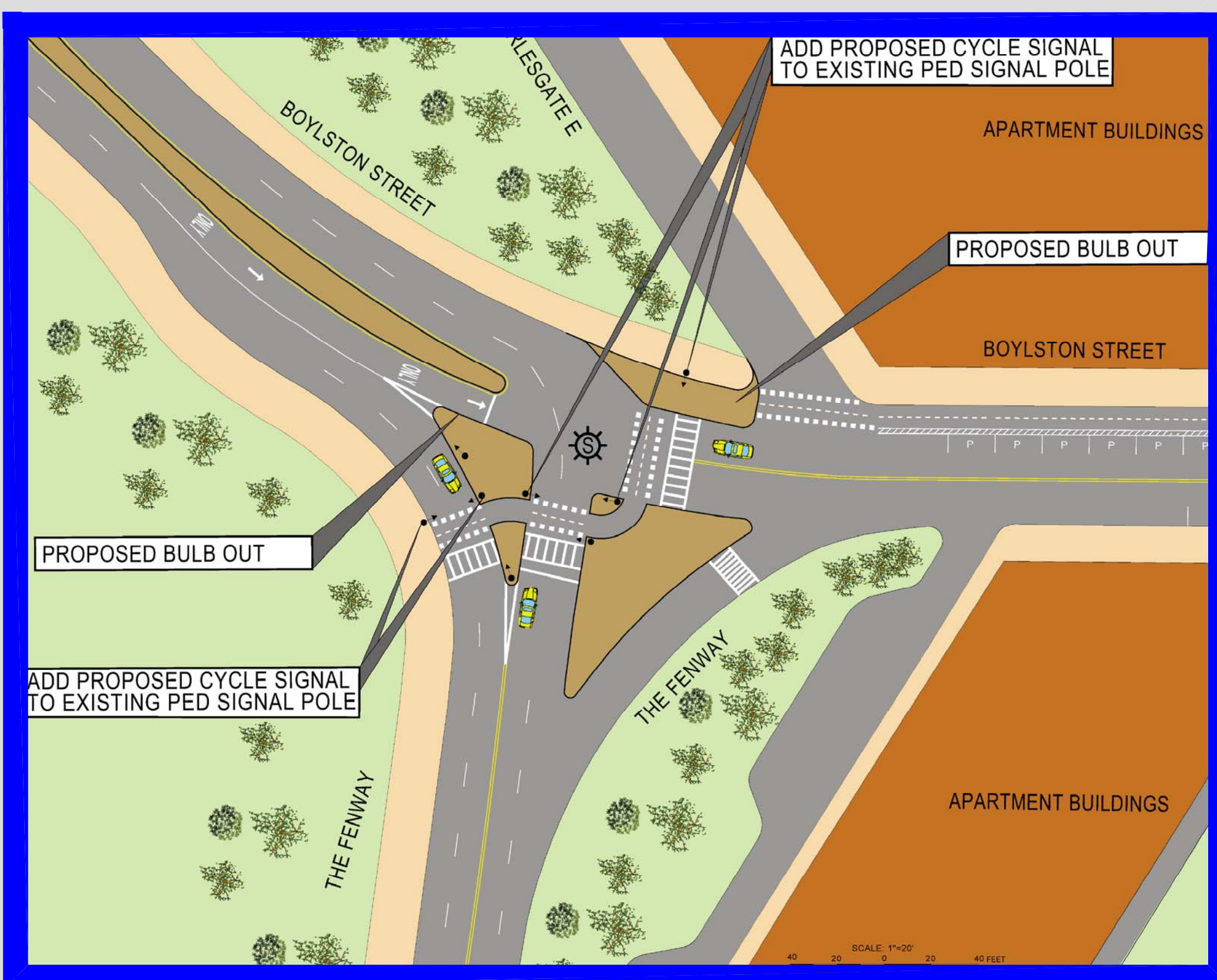

BOYLSTON STREET AT THE FENWAY

- CONNECTION TO THE BACK BAY FENS AND MUDDY WATER BICYCLE PATH
- PROPOSED BULB OUT TO IMPROVE VEHICULAR MOVEMENTS AND FOR PEDESTRIAN REFUGE
- AT GRADE BICYCLE CROSSINGS

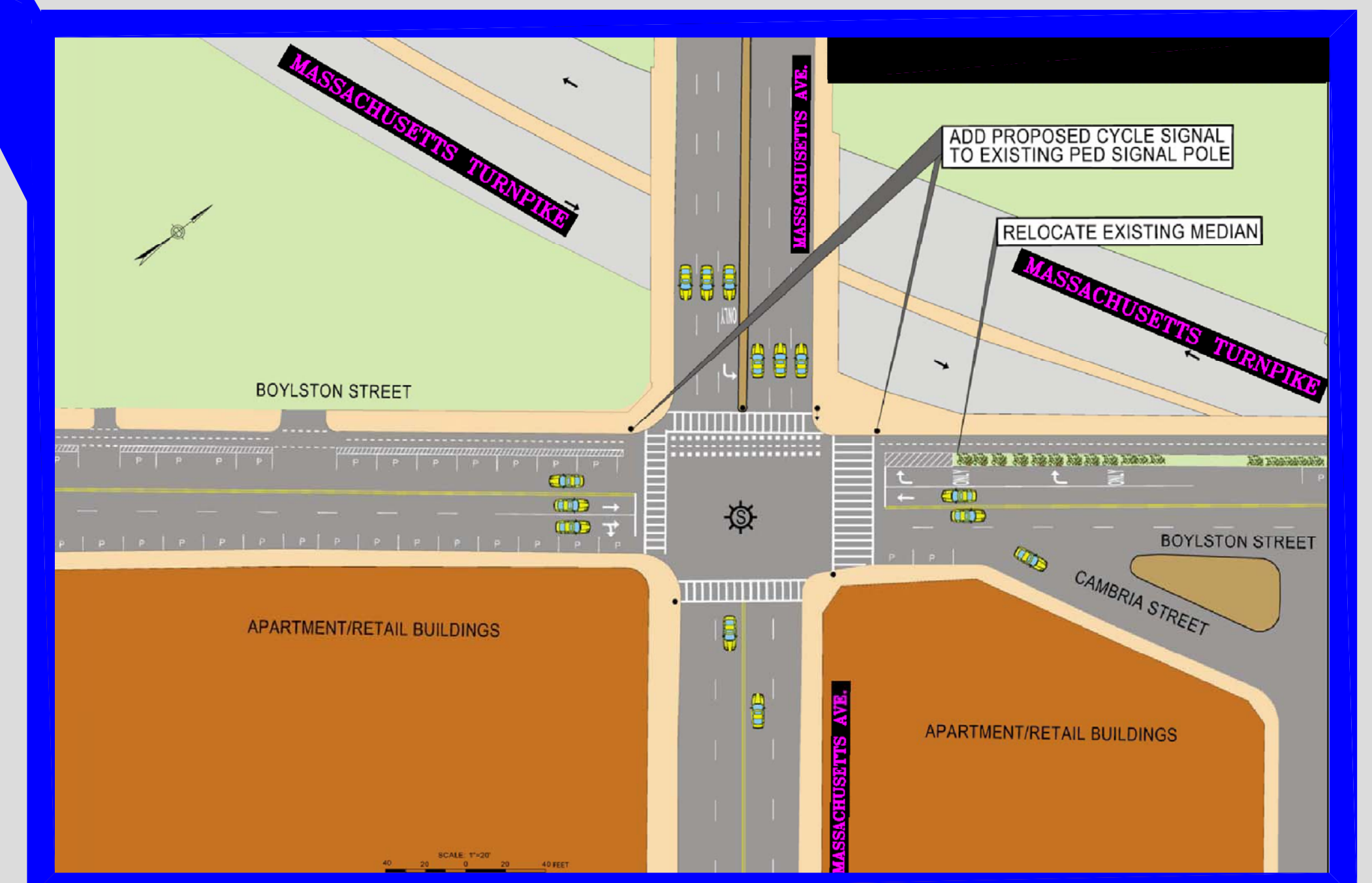

BOYLSTON STREET AT MASSACHUSETTS AVENUE

- RELOCATION OF VEGETATED MEDIAN FOR ADDED SEPARATION AND PROTECTION FOR BICYCLES